

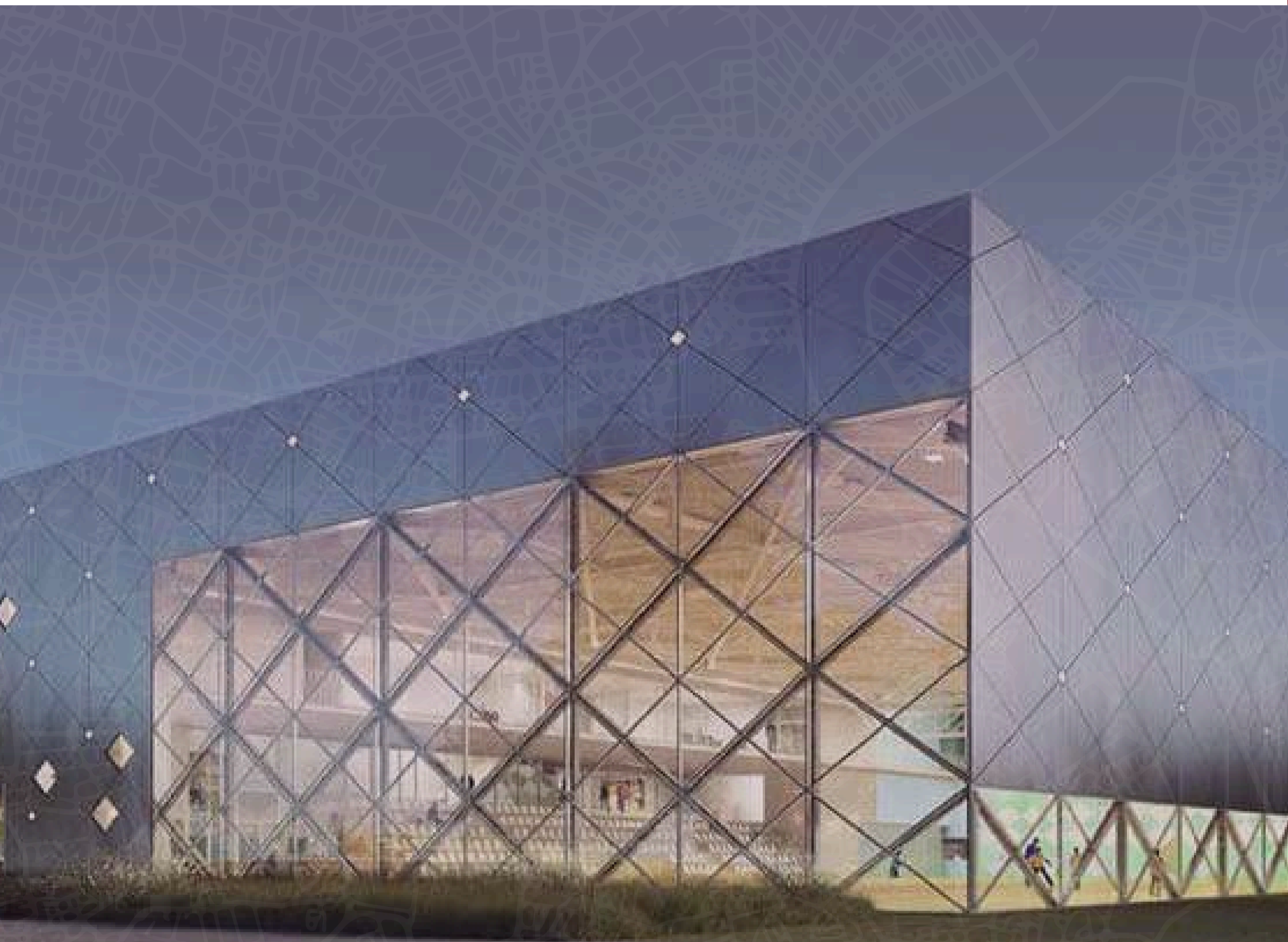

FISU
WORLD
UNIVERSITY
CHAMPIONSHIP
HANDBALL



BULLETIN N°2

21-27 June 2026

<https://handball2026.fisu.net>

WELCOME



FISU
WORLD
UNIVERSITY
CHAMPIONSHIP
HANDBALL



Dear student-athletes, dear friends,

On behalf of the New-Aquitaine University Sports League, it is a true pleasure to welcome you to Pessac, at the heart of Bordeaux Métropole, for the 2026 World University Handball Championship. This event, which brings together some of the world's best university handball players, reflects our shared passion for sport and its values.

Throughout the week, Pessac will showcase respect, solidarity, and cultural exchange — the very spirit of university sport.

Here, competition goes hand in hand with sharing experiences, discovering new cultures, and creating lasting memories.

We warmly thank the University of Bordeaux, the City of Pessac, Bordeaux Métropole, our partners, and all the volunteers for their dedication and commitment. Their support embodies the energy and diversity of our region.

To all participants, may you give your best, embrace every moment, and discover the charm and hospitality of our region. We wish you a successful championship and an unforgettable stay in Bordeaux.

Patrice SCLEAR

Director of the New-Aquitaine University Sports League

PROGRAMME



WE ARE WAITING FOR YOU !



The Bordeaux quays



The Water Mirror



The SMART



The dune of Pilat



The Bellegrave Sports Hall



The Grand Theatre

DELEGATION SERVICES

“ —

Dear participants,



Welcome to all delegation members. Our priority is to ensure you have a pleasant and carefree stay so that you can fully focus on the competition.

We have carefully selected hotels for your comfort, and we have planned every meal to meet your dietary needs.

Ludovic PIGEOT - Delegations Services Manager

“ —

Dear participants,

We are delighted to welcome all delegation members. Our aim is to provide a comfortable and stress-free stay, allowing you to focus fully on your performance.

To make your experience as enjoyable as possible, we have selected quality accommodation and arranged catering services tailored to a variety of dietary needs and preferences.

Polina MIKHALEVA - Delegations Services Manager



CATERING

- *BREAKFAST from 7:00 to 9:00 a.m.*
- *LUNCH from 11:00 a.m. to 1:45 p.m.*
- *DINNER from 6:00 to 8:30 p.m.*
- *Ingredients and allergen information will be clearly displayed for all dishes and salads in order to accommodate dietary requirements as much as possible.*
- *With sustainability in mind, the OC will not be supplying plastic water bottles. Remember to bring your own water bottle to fill at the various water points.*



All meals will be served at the Sirtaki restaurant.

ACCOMMODATION



Accommodation will be provided in student residences through our partner, CROUS Nouvelle-Aquitaine. Each university residence will be assigned according to availability. CROUS accommodation only consists of single rooms. A campus map and access details are provided below.

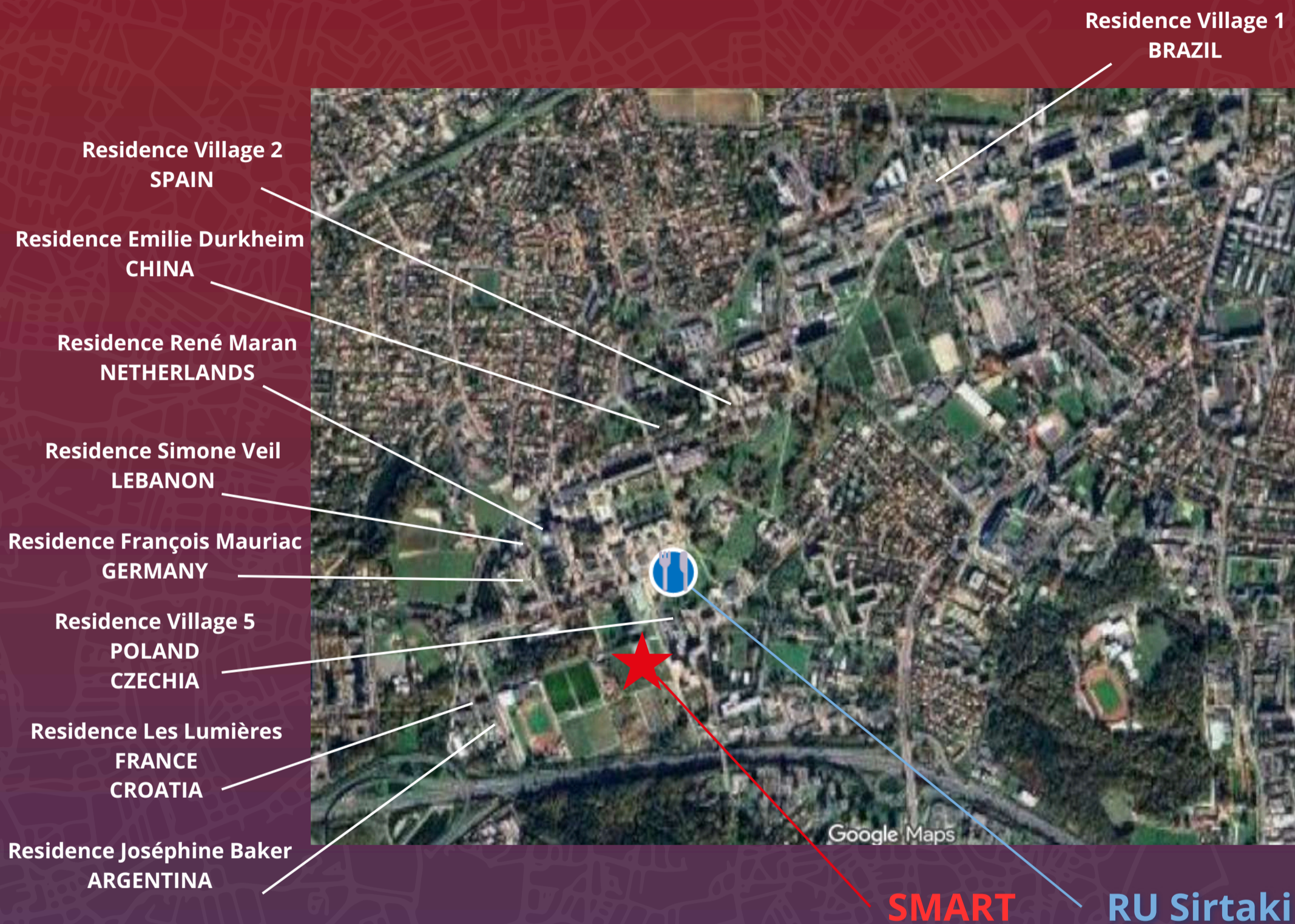

LAUNDRY SERVICE

We offer a laundry service for your team's equipment. This is a paid service, payable by credit card. Each delegation will receive one IZLY card to use the laundry facilities. A CROUS laundromat is located near each residence for your convenience.

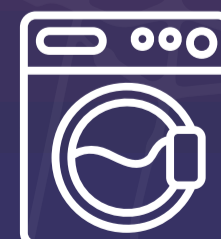

LOGISTICS

“ —

Dear participants,



I am pleased to welcome you and ensure that your stay runs as smoothly as possible.

Our team is fully committed to organizing all logistics and transportation needs, so you can focus entirely on your event and performance.

Should you require any assistance regarding transport, schedules, or logistics, our team will be available at all times to support you.

Laurent QUEYRET- Logistics and Transport Manager

GENERAL INFORMATION



PADLET

The medical service for the World Handball Championship is designed to ensure the safety and well-being of all participants throughout the competition.



Each competition venue is equipped with a dedicated on-site doctor, supported by trained medical staff ready to respond quickly to any injury or emergency situation. A coordinated medical system is in place to provide efficient and immediate care.

A dedicated medical shuttle is available to transport injured participants to appropriate healthcare facilities when needed. A coordinating physician oversees all medical decisions and ensures proper orientation to partner hospitals and clinics, including the Clinique Mutualiste de Pessac, the Clinique du Sport de Mérignac, the Bordeaux University Hospital (CHU de Bordeaux), and the medical service of the CREPS of Bordeaux.

For any medical assistance, please contact the emergency medical number :

+33 6 68 92 12 73.

MEDICAL

TRANSPORTATION



Each delegation will be welcomed at the airport or train station according to their travel plan. Upon arrival, they will receive their transportation schedule for the entire stay, including transfers between accommodation, training, and competition venues.

A TBM Congress Pass valid on the entire Bordeaux Metropolitan public transport network will be provided with each accreditation. It is valid for 11 days — please keep it safe, as no replacement pass will be issued.

WUC HANDBALL 2026 VILLAGE AT THE HEART OF THE CAMPUS

Competition site - Venue unit

Catering

Accommodation

2 competition sites nearby
=> 3 km distance

Tramway B :
Pessac station
=> Campus = 9 min

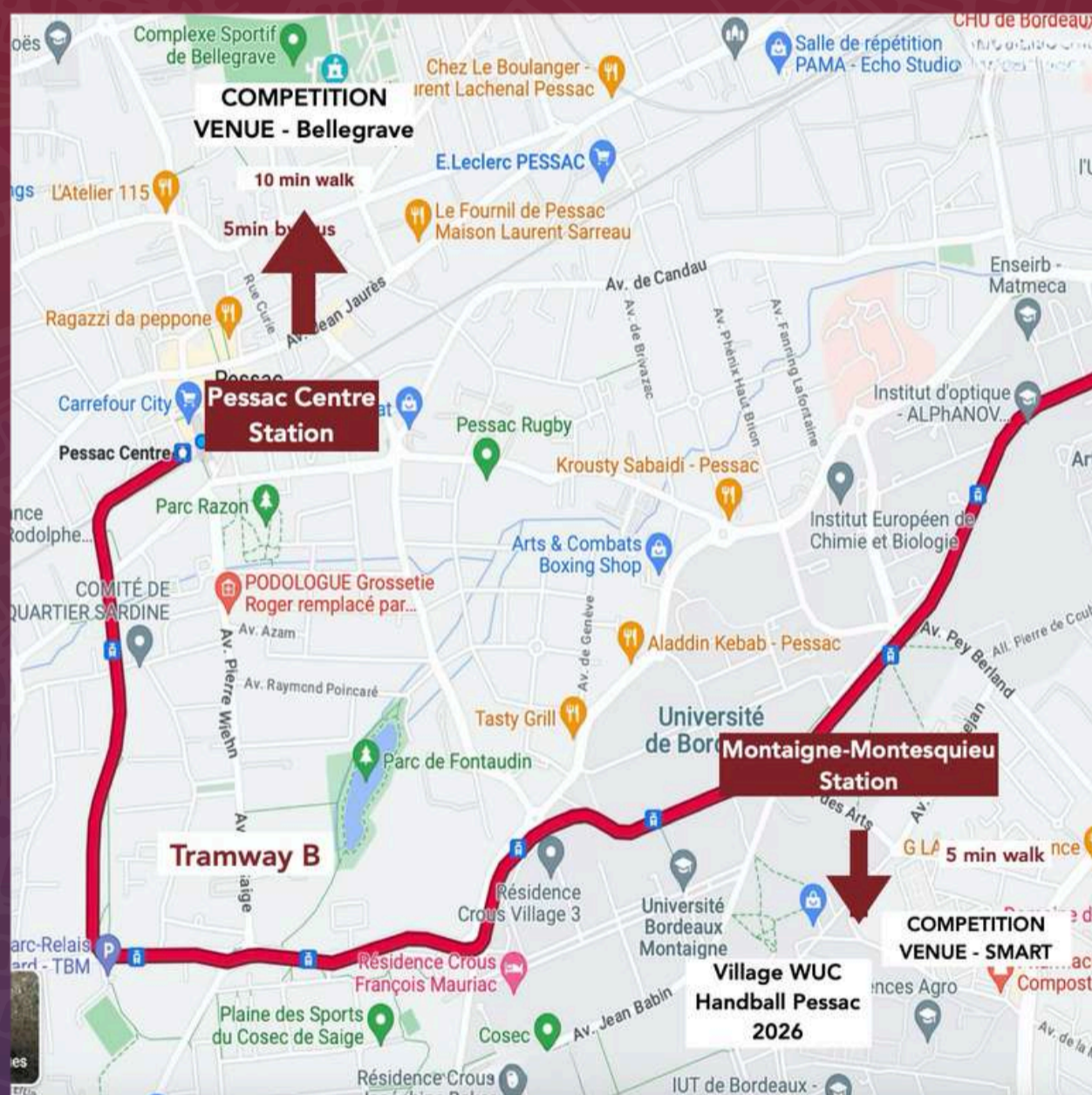

Acting as the central hub of the Championship, SMART benefits from its ideal location near participants' accommodations and various dining options.

Shuttle departures will be organized for teams competing at the Bellegrave venue, ensuring smooth transfers between sites. Each delegation will also receive a detailed transportation plan to help them navigate easily throughout the event

VENUES



The SMART building of the University of Bordeaux will serve as one of the official competition venues, hosting the official training sessions starting on June 18, 2026. On June 20, it will also be the stage for the Opening Ceremony, surrounded by a lively animation village offering activities and entertainment for all participants and visitors.

The SMART (Sports Management, Advanced Research and Technologies) building is a modern sports facility located on the campus. It combines high-level sports infrastructures with spaces dedicated to research, innovation, and education in sport sciences, making it a key hub for both athletic performance and academic excellence.



Ville de
PESSAC

The Bellegrave Sports Hall, located in the city of Pessac, will serve as the second official competition venue of the Championship. It will host the final stages of the tournament, as well as the Closing Ceremony and the Gala event.

With a capacity of nearly 1,200 seated spectators, Bellegrave is also home to the emblematic SPUC Handball Club, a key player in the local sports community.

Shuttle transfers will be organized for delegations to and from the main village, ensuring smooth and convenient transportation throughout the event.





FISU
WORLD
UNIVERSITY
CHAMPIONSHIP
HANDBALL

TRAVEL GUIDE

HOW TO GET TO SMART



BY WALKING

LES LUMIÈRES | JOSÉPHINE BAKER → **5 min** along Avenue Jean Babin

VILLAGE 5 → **3 min** along street Paulin de Nole

FRANÇOIS MAURIAC → **7 min** along Esplanade des Antilles

SIMONE VEIL | RENÉ MARAN → **8 min** along Esplanade des Antilles



BY TRAM B – STOP STATION: “Montaigne-Montesquieu”

VILLAGE 1 → From “**Arts et métiers**” Tram stop



then Walk **8min** along
Avenue Jean Lartaud to
SMART

EMILE DURKEIM

→ From “**Doyen Brus**” tram Stop

VILLAGE 2

SMART ↔ BELLEGRAVE

Walk ≈ 10 min

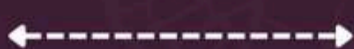

TRAM B



Walk ≈ 15 min

SMART
Venue



Tram Stop
“Montaigne-Montesquieu”



Tram Stop
“Pessac Centre”



BELLEGRAVE
Venue



TBM
TRANSPORT
TIMETABLES



FISU
WORLD
UNIVERSITY
CHAMPIONSHIP
HANDBALL

TRAVEL GUIDE

HOW TO GET TO BELLEGRAVE



TRAINING SESSION

WALK TRAM B | TOWARDS PESSAC CENTRE

FROM
UNITEC

LES LUMIÈRES

VILLAGE 5

FRANÇOIS MAURIAC

JOSÉPHINE BAKER

SIMONE VEIL

RENÉ MARAN

FROM
DOYEN BRUS

VILLAGE 2

EMILE DURKEIM

FROM
ARTS ET MÉTIERS TRAM STOP

VILLAGE 1

TBM TRAM
TIMETABLES



OFFICIAL GAME

TRANSPORT PROVIDED BY THE ORGANIZING COMMITTEE (2 TEAMS ONLY)

DEPARTURE
FROM **UNITEC**

GAME
TIME

DEPARTURE
FROM **BELLEGRAVE**

RETURN TO

7 h 15

9 h 15

12h00

UNITEC

9 h 30

11 h 30

13 h 20

UNITEC

11 h30

13 h 30

15 h 35

UNITEC

13 h 45

15 h 45

17 h 45

UNITEC

16 h 00

18 h 00

20 h 00

SIRTAKI

18 h 00

20 h 15

22 h 10

SMART

FINALS AND CLOSING CEREMONY

DEPARTURE **UNITEC**

GAME TIME

RETURN

14 h 00

16 h 00

BY TRAM B

16 h 00

18 h 00

FOR ALL

COMPETITION



Dear participants and supporters,



Welcome to the competition area, where men's and women's teams from all over the world will compete with passion and determination. Get ready for intense and exciting matches, where each team will give its all in pursuit of victory.

Let us support these extraordinary athletes and enjoy the excitement and passion of handball together !

Clémence CASTET - Sport Manager

DELEGATIONS

WOMEN'S DELEGATIONS

BRAZIL 

CHINA 

CZECHIA 

FRANCE 

GERMANY 

NETHERLANDS 

POLAND 

SPAIN 

MEN'S DELEGATIONS

ARGENTINA 

BRAZIL 

CROATIA 

CZECHIA 

FRANCE 

LEBANON 

POLAND 

SPAIN 



FISU
WORLD
UNIVERSITY
CHAMPIONSHIP
HANDBALL

OFFICIAL GROUP DRAW

WOMEN'S DRAW

GROUP A



GROUP B



MEN'S DRAW

GROUP C



GROUP D



DATE	DAY	🏠 BELLEGRAVE				🏠 SMART			
		Time	Match	W/M	Pool/Round	Time	Match	W/M	Pool/Round
Saturday 20 June	Opening Match	20h30	France – Netherlands	W	Group A (W)	–	–	–	–
Sunday 21 June	Day 1	13h30	Spain – Germany	W	Group B (W)	13h30	Czechia – Brazil	W	Group B (W)
		15h45	Spain – Croatia	M	Group D (M)	15h45	Czechia – Argentina	M	Group D (M)
		18h00	Poland – China	W	Group A (W)	18h00	Poland – Lebanon	M	Group C (M)
		20h15	France – Brazil	M	Group C (M)	20h15	–	–	–
Monday 22 June	Day 2	13h30	Argentina – Spain	M	Group D (M)	13h30	Czechia – Croatia	M	Group D (M)
		15h45	Brazil – Spain	W	Group B (W)	15h45	Czechia – Germany	W	Group B (W)
		18h00	Lebanon – France	M	Group C (M)	18h00	Poland – Brazil	M	Group C (M)
		20h15	China – France	W	Group A (W)	20h15	Poland – Netherlands	W	Group A (W)
Tuesday 23 June	Day 3	13h30	Spain – Czechia	W	Group B (M)	13h30	Germany – Brazil	W	Group B (W)
		15h45	Spain – Czechia	M	Group D (M)	15h45	Croatia – Argentina	M	Group D (M)
		18h00	France – Poland	W	Group A (W)	18h00	Netherlands – China	W	Group A (W)
		20h15	France – Poland	M	Group C (M)	20h15	Brazil – Lebanon	M	Group C (M)
🏠 Wednesday – 24 June 🏠 DAY OFF — No matches									
Thursday 25 June	Quarter-Finals	13h30	QF	W	Women QF	13h30	QF	W	Women QF
		15h45	QF	M	Men QF	15h45	QF	M	Men QF
		18h00	QF	W	Women QF	18h00	QF	W	Women QF
		20h15	QF	M	Men QF	20h15	QF	M	Men QF
Friday 26 June	Semi-Finals + Rankings	13h30	Ranking 5-8 n°1	W	Placement	13h30	Ranking 5-8 n°2	W	Placement
		15h45	Ranking 5-8 n°1	M	Placement	15h45	Ranking 5-8 n°2	M	Placement
		18h00	SF	–	–	18h00	SF	–	–
		20h15	SF	–	–	20h15	SF	–	–
Saturday 27 June	Finals Day 🏆	09h15	Ranking 7-8	M	Placement	09h15	Ranking 7-8	W	Placement
		11h30	Ranking 5-6	W	Placement	11h30	Ranking 5-6	M	Placement
		13h45	Ranking 3-4	M	Placement	13h45	Ranking 3-4	W	Placement
		16h00	FINAL	W	Women Final	–	–	–	–
		18h15	FINAL	M	Men Final	–	–	–	–
		20h30	Closing Ceremony	–	–	–	–	–	–

* schedule subject to change with the approval of FISU and the IHF delegate

TRAINING

THURSDAY 18 JUNE				
HOUR	BELLEGRAVE	SMART	SO	COSEC
10:00	France (M)			
11:00				
13:00				
14:00				
15:00				
16:00	Brazil (M)			
17:00	Argentina (M)			
18:00				

FRIDAY 19 JUNE				
HOUR	BELLEGRAVE	SMART	SO	COSEC
8:00				
9:00	Croatia (M)			
10:00	Czechia (M)	Poland (W)		
11:00	Czechia (W)	China (W)		
12:00				
13:00				
14:00	Poland (M)	Brazil (M)		
15:00	France (W)	Argentina (M)		
16:00	Spain (W)			
17:00	Spain (M)	Prépa CO		
18:00	Brazil (W)			

SATURDAY 20 JUNE				
HOUR	BELLEGRAVE	SMART	SO	COSEC
8:45	Germany (W)		Czechia (M)	
9:30	Netherland (W)		Czechia (W)	
10:15	Lebanon (M)		Brazil (W)	
11:00	Argentina (M)	Prépa CO	Brazil (M)	
11:45	Poland (W)		Croatia (M)	
12:30	China (W)		Poland (M)	
13:15	Spain (M)		Spain (W)	
16:00		CO		
20:30	France - Netherlands			

SUNDAY 21 JUNE				
HOUR	BELLEGRAVE	SMART	SO	COSEC
8:15			Training	Training without ball
9:00			Training	Training without ball
9:45			Training	Training without ball
10:30			Training	Training without ball
11:15			Training	Training without ball
12:00			Training	Training without ball
12:45			Training	Training without ball
13:30	Spain - Germany	Czechia - Brazil		
15:45	Spain - Croatia	Czechia - Argentina		
18:00	Poland - China	Poland - Lebanon		
20:15	France - Brazil			

MONDAY 22 JUNE				
HOUR	BELLEGRAVE	SMART	SO	COSEC
8:15			Training	Training without ball
9:00			Training	Training without ball
9:45			Training	Training without ball
10:30			Training	Training without ball
11:15			Training	Training without ball
12:00			Training	Training without ball
12:45			Training	Training without ball
13:30	Argentina - Spain	Czechia - Croatia		
15:45	Brazil - Spain	Czechia - Germany		
18:00	Lebanon - France	Poland - Brazil		
20:15	China - France	Poland - Netherlands		

TUESDAY 23 JUNE				
HOUR	BELLEGRAVE	SMART	SO	COSEC
8:15			Training	Training without ball
9:00			Training	Training without ball
9:45			Training	Training without ball
10:30			Training	Training without ball
11:15			Training	Training without ball
12:00			Training	Training without ball
12:45			Training	Training without ball
13:30	Spain - Czechia	Germany - Brazil		
15:45	Spain - Czechia	Croatia - Argentina		
18:00	France - Poland	Netherlands - China		
20:15	France - Poland	Brazil - Lebanon		

WEDNESDAY 24 JUNE				
HOUR	BELLEGRAVE	SMART	SO	COSEC
DAY OFF				
10:00	Spain (W)	Czechia (W)		
10:45	Germany (W)	Brazil (W)		
11:30	Spain (M)	Czechia (M)		
12:15	Croatia (M)	Argentina (M)		
13:00	France (W)	Poland (W)		
13:45	Netherland (W)	China (W)		
14:30	France (M)	Poland (M)		
15:15	Brazil (M)	Lebanon (M)		

THURSDAY 25 JUNE				
HOUR	BELLEGRAVE	SMART	SO	COSEC
8:15			Training	Training without ball
9:00			Training	Training without ball
9:45			Training	Training without ball
10:30			Training	Training without ball
11:15			Training	Training without ball
12:00			Training	Training without ball
12:45			Training	Training without ball
13:30	QF	QF		
15:45	QF	QF		
18:00	QF	QF		
20:15	QF	QF		

FRIDAY 26 JUNE				
HOUR	BELLEGRAVE	SMART	SO	COSEC
8:15			Training	Training without ball
9:00			Training	Training without ball
9:45			Training	Training without ball
10:30			Training	Training without ball
11:15			Training	Training without ball
12:00			Training	Training without ball
12:45			Training	Training without ball
13:30	M ranking 5-8 n°1 (W)	M ranking 5-8 n°2 (W)		
15:45	M ranking 5-8 n°1 (M)	M ranking 5-8 n°2 (M)		
18:00	SF	SF		
20:15	SF	SF		

SATURDAY 27 JUNE				
HOUR	BELLEGRAVE	SMART	SO	COSEC
8:15			Training	Training without ball
9:00			Training	Training without ball
9:15	M ranking 7-8 (M)	M ranking 7-8 (W)		
9:45				
10:30			Training	Training without ball
11:15				
11:30	M ranking 5-6 (W)	M ranking 5-6 (M)		
12:00				
12:45			Training	Training without ball
13:45	M ranking 3-4 (M)	M ranking 3-4 (W)		
15:45	Final (W)			
18:00	Final (M)			
20:15	CC			

LEGEND

	France		China
	Brazil		Lebanon
	Argentina		Training / Prépa CO
	Spain		QF
	Poland		SF
	Germany		Final (W)
	Netherlands		Final (M)
	Croatia		CC
	Czechia		

NOTES

(M) = Men (W) = Women
 CO = Opening Ceremony CC = Closing Ceremony
 SO = Salle Omnisports

SPORT REGULATIONS

The Handball tournaments shall be organised following the most recent Technical Regulations of the International Handball Federation (IHF). In case of dispute in the interpretation of the rules, the English text shall be regarded as authoritative

1. Match point system

Teams will compete against one another in each group on a round-robin basis. Match points will be awarded for each group match according to the following criteria :

- Win = 2 points
- Draw = 1 point
- Loss = 0 point

No extra time shall be played during the group phase

2. Classification criteria

The ranking of each team in each group will be determined as follows :

- Higher number of points obtained in all group matches
- Goal difference across all group matches
- Higher number of goals scored in all group matches
- Goal ratio - the number of goals scored divided by the number of goals conceded

If two or more teams are equal on the basis of the above four criteria, their rankings will be determined as follows :

- Higher number of points obtained in the group matches between the teams involved
- Goal difference derived from the group matches contested between the teams involved
- Higher number of goals scored in all group matches between the teams involved
- A draw conducted by the local organizing committee, in the presence of the team captains

This is a full ranking tournament, meaning that teams will compete for every position in the final standings

3. Delegations composition

Each country is allowed to enter a maximum of 16 athletes per tournament and per game.

4. Final stages

The placement matches (5-8), quarter-finals, semi-finals and finals shall be played in a knockout system.

For these matches : the placement matches (5-8), quarter-finals and semi-finals, in case of a draw at the end of the regular playing time, a direct 7-metre shoot-out shall be used to determine a winner in accordance with Rule 2:2 of the Rules of the Game (IHF).

For the finals (medal matches), overtime is played following a 5-minute break, if a match is tied at the end of the regular playing time. The overtime period consists of two (2) halves of five (5) minutes, with a 1-minute half-time break.

If the match is again tied after the first overtime period, a second period is played after a 5-minute break. This overtime period also consists of two (2) halves of five (5) minutes, with a 1-minute half-time break. Should the match still not be decided after the second overtime period, the winner is determined through a 7 m shoot-out in accordance with Rule 2:2 of the Rules of the Game (IHF).

5. Match scheme

Main round :

Group A (Women)	Day 1 : 1 - 3 & 2 - 4
Group B (Women)	Day 2 : 4 - 1 & 2 - 3
Group C (Men)	Day 3 : 3 - 4 & 1 - 2
Group D (Men)	

Quarter-finals (W):

- QF 1 = 1 Group A - 4 Group B
- QF 2 = 2 Group A - 3 Group B
- QF 3 = 3 Group A - 2 Group B
- QF 4 = 4 Group A - 1 Group B

Placement matches :

- PM 1 = LQF 1 - LQF 3
- PM 2 = LQF 2 - LQF 4
- 5/6 = WPM 1 - WPM 2
- 7/8 = LPM 1 - LPM 2

Quarter-finales (M):

- QF 1 = 1 Group C - 4 Group D
- QF 2 = 2 Group C - 3 Group D
- QF 3 = 3 Group C - 2 Group D
- QF 4 = 4 Group C - 1 Group D

Semi-finals :

- SF 1 = WQF 1 - WQF 3
- SF 2 = WQF 2 - WQF 4
- 1/2 = WSF 1 - WSF 2
- 3/4 = LSF 1 - LSF 2

ACCREDITATION



“ —

Accreditation is essential to ensure that our event runs smoothly and safely. We are counting on your cooperation to ensure that everything goes as planned.

Olivier AUPY - Accreditation and ticketing Manager

PROCEDURE

First step :

Upon arrival, you will receive a provisional accreditation granting access to the designated areas of the event.

Second step :

An appointment will be made at the accreditation center (STAPS Faculty - rooms A and B) with the head of delegation to finalize the procedure. They will collect all the accreditations of their delegation's members.



Third step :

Once your HoD has provided you with your accreditation, you will officially be part of the event !



TICKET OFFICE

GENERAL PUBLIC TICKETS

The admission fee for spectators is 5€

Click on the ticketing link corresponding to the venue of the match you wish to attend :

- **SMART Venue Ticket Office:**

<https://plusbilletterie.helloasso.com/fr/evenements/6a0c63de68a63950111bc49a>

- **Bellegrave Venue Ticket Office:**

<https://plusbilletterie.helloasso.com/evenements/6a0b0fce8022dcf0aa4a1ffb>

Select the match(es) you would like to attend.

Confirm your order and proceed with the secure payment.

Receive your tickets by email and present them on the day of the event.

Tickets can only be purchased online.

Free admission for children under 12 years of age.



**Ticket office
BELLEGRAVE**



**Ticket office
SMART**



COMMUNICATION



Communication is key to the success of our event. We have set up several channels to keep you informed and to share this adventure with as many people as possible.

Our aim is to provide a comprehensive and dynamic coverage of the championship, so that you can follow every key moment, whether you are on site or following the event remotely.

Auxane VEROVE-BIASSE - Communication Manager

The Communications Department is pleased to inform you that the championship will be broadcast live on FISU TV, allowing you to follow the event wherever you are.

You can access the live broadcasts via the following link :

[FISU TV](#)

In addition to the broadcasts, we invite you to stay connected to the latest news, highlights, and behind-the-scenes content by following our official Instagram account throughout the competition.

All official information, schedules, results, and news will also be available on the event's official website, which serves as the main source of information during the championship.

Stay connected across all platforms and enjoy the full experience of the event !

BROADCAST

SOCIAL MEDIA



<https://handball2026.fisu.net>

[FISUHANDBALL](#)



[FISUHANDBALL](#)

VILLAGE



The World University Handball Championship Village will be set up around the SMART building, at the heart of the event between the competition hall, training areas, and athletes' rest zone.



Open to all, the Village will offer handball workshops, student association booths, and stands showcasing local culture and products, along with relaxation areas and outdoor games. Conferences on the technical, educational, and medical aspects of handball will also take place.

Bernard Gresser – Village Manager

Activities and Program

Throughout the championship, an Entertainment Village will be available to all participants, providing a friendly and welcoming space to relax, socialize, and enjoy a variety of activities outside the competition.

A programme of entertainment, sports activities, and social events will be offered throughout the week to enhance your experience and encourage exchanges between delegations.

The detailed entertainment programme will be communicated shortly through the event's official communication channels.

We look forward to welcoming you to the Entertainment Village and sharing memorable moments together.

SPORTS & CHALLENGES				ENTERTAINMENT		SOCIAL & RELAX	
ARCHERY	LASER RUN	BEACH VOLLEYBALL	FOOTBALL	KARAOKE	BLIND TEST	BODEGA	CHILL ZONE
PICKLEBALL	BUBBLES FOOTBALL	MÖLKKY	TABLE TENNIS	DJ SESSIONS	PHOTOBOOTH	MEETING POINT	INTERNATIONAL EXCHANGE
PETANQUE	DARTS	CORNHOLE	PALETS BRETONS				



FISU
WORLD
UNIVERSITY
CHAMPIONSHIP
HANDBALL

SAFE ZONE

NEED HELP ?

Victim or witness of a problematic situation?

The Safe Zone is available on site :



CONTACT :

+33 7 44 42 98 80



PESSAC BORDEAUX METROPOLE 2026

FISU
WORLD
UNIVERSITY
CHAMPIONSHIP
HANDBALL



Ville de
PESSAC

université
de **BORDEAUX**



FFHANDBALL



LIGUE NOUVELLE
AQUITAINE
FFHANDBALL



COMITÉ
GIRONDE
FFHANDBALL



OUR PARTNERS

FISU WORLD UNIVERSITY HANDBALL
CHAMPIONSHIP 2026

CONTACT US

GENERAL ORGANIZATION

FISU WUC Handball 2026

wuchandball2026@sport-u.com



Useful Numbers

Delegation Services : +33 6 99 39 26 07

Security : +33 6 99 38 90 83

Medical : +33 6 63 92 12 73

SAFE ZONE Need Help ?

Have you experienced or witnessed inappropriate behaviour ?

Contact +33 6 44 42 98 80



PESSAC BORDEAUX METROPOLE 2026

FISU
WORLD
UNIVERSITY
CHAMPIONSHIP
HANDBALL